

REAR WINDSCREEN SHADE INSTALLATION GUIDE

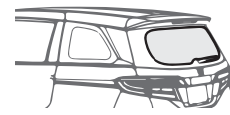

Groovy

! **AVOID** use of sunshade when driving vision is impaired

RC1-A

Parts List

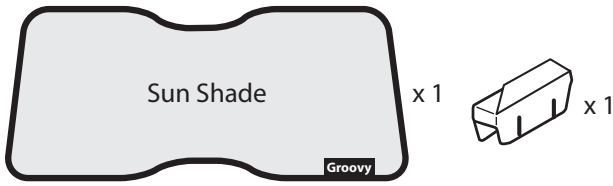

Recommended Clip Installation Positions

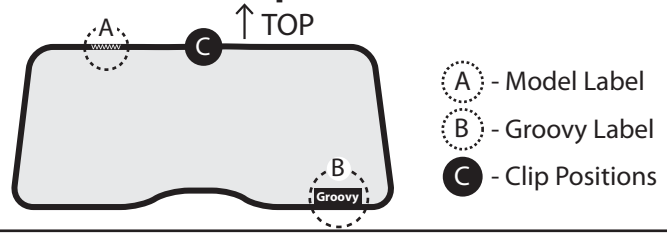

Installation Guide

1a. Place clip to the side of the steel frame.

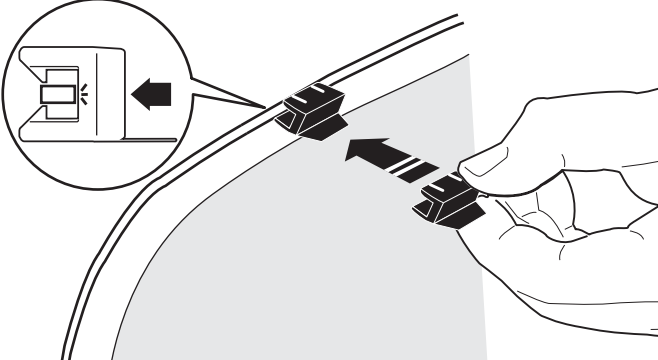

1b. Push clip upwards to fasten clip onto steel frame.

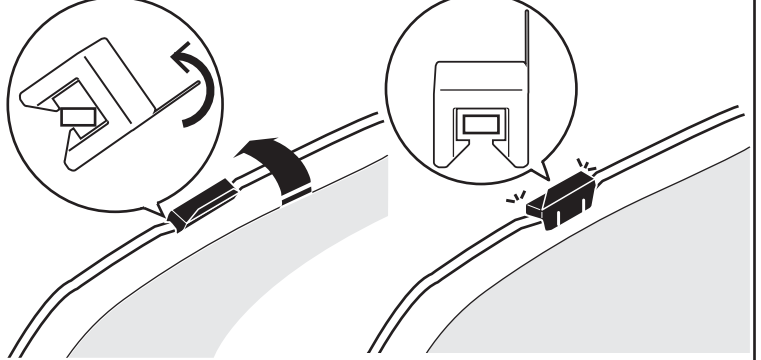

2. With the top clip locked into place, push the top section of the shade into the trim panel. The flat tip of the clip will sit in between the trim panel and the windscreen glass.

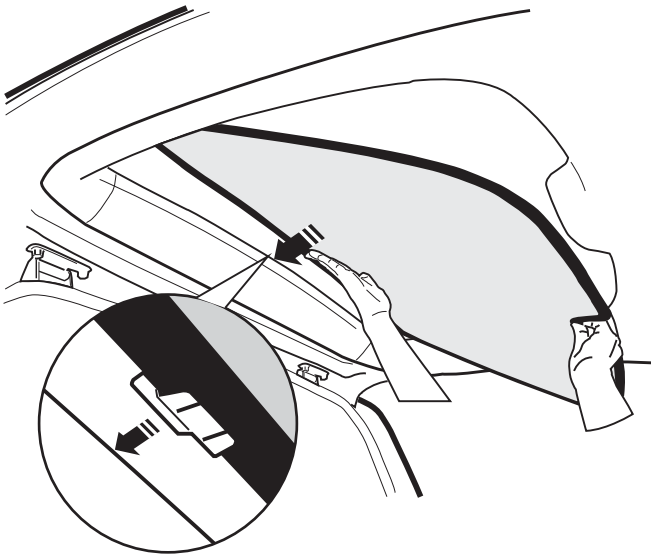

3. Insert bottom section of the shade into bottom trim panel.

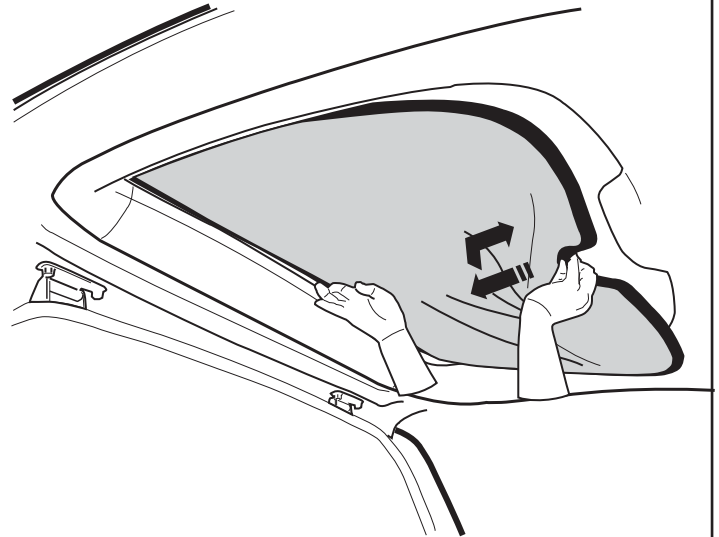

4. If the rear windscreen shade is unable to fit nicely into the rear panel trims, do switch the sides of the shade (see illustration below) and repeat Step 2 - 3 again.

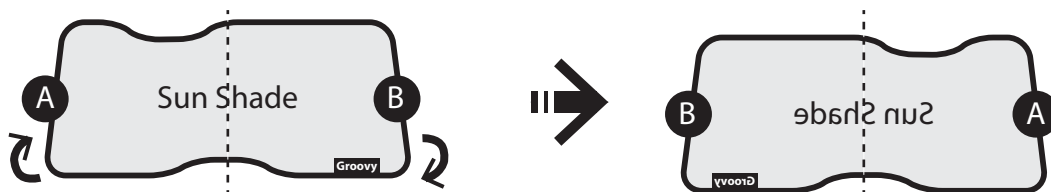

The rear windscreen shade is foldable

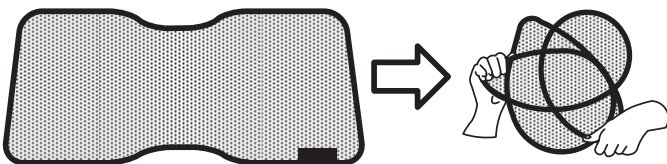

! **Warning :** The high tension from the collapsed steel frame may cause injury. Please be cautious when unfolding the collapsed rear shade.