

*"Groovy Snap-On 5.0 will feature the steel L-Clips + sunshades with embedded magnets. The usage of the L-Clips and the sunshades with embedded magnets will allow vehicles with plastic panels at the window frame to use the magnet mounting system."*

The above diagram is for illustration only. Shape of shades and magnet positions will differ from model to model.

## ■ Finding embedded magnet position

The magnets are located at the top of the sunshades.

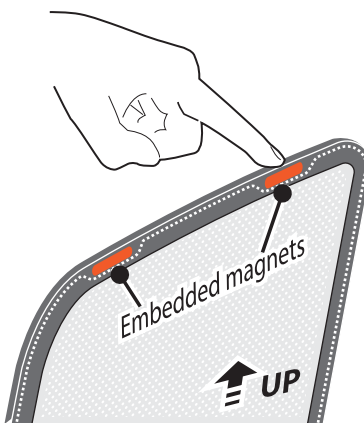
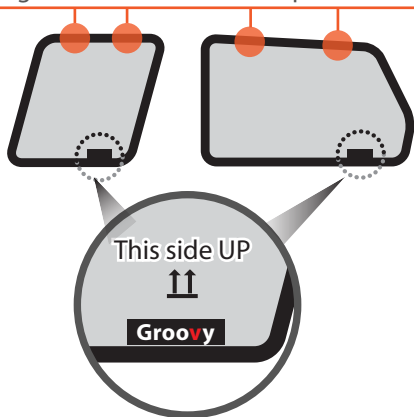

1

The position of the magnets can be felt by running your finger over the top side of the sunshade's frame. You will feel an indentation on the frame and that is the position of the magnet.

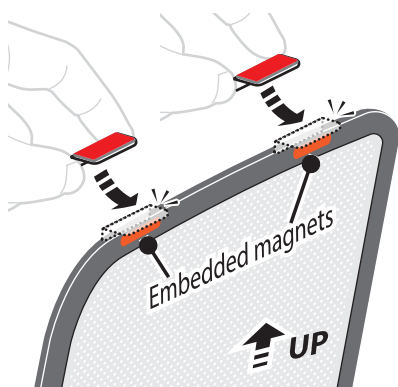
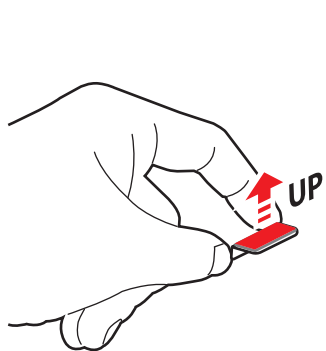

Note: Do not remove protective layer on adhesive tape

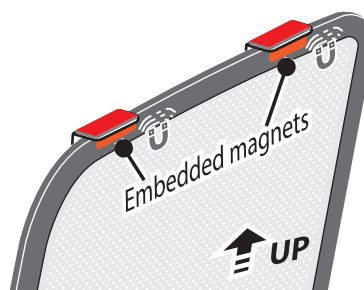

2

Place the L-Clips at the magnet locations of the sunshade.

Repeat the process for the remaining sunshades.

## ■ Positioning of sunshade and L-Clips

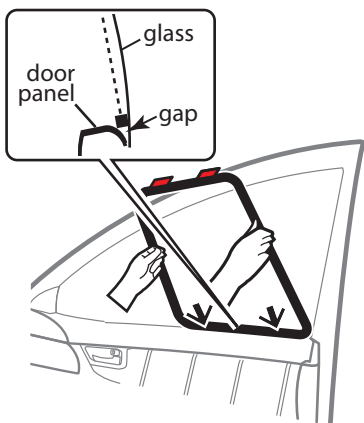

3

Place sunshade into the bottom gap between the door panel and window.

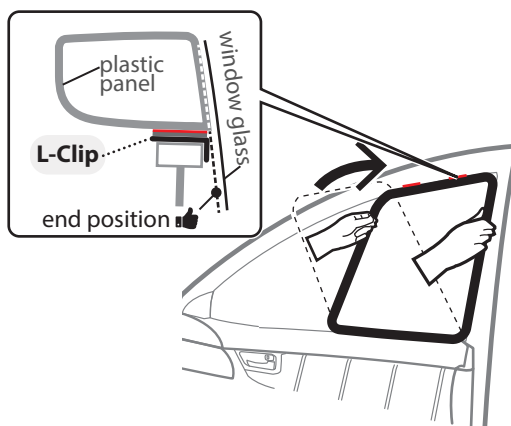

4

Place sunshade with the L-clips attached to the plastic panel to the window of the vehicle to find the best position for the sunshade and L-clips.

Note: Do not remove protective layer on adhesive tape

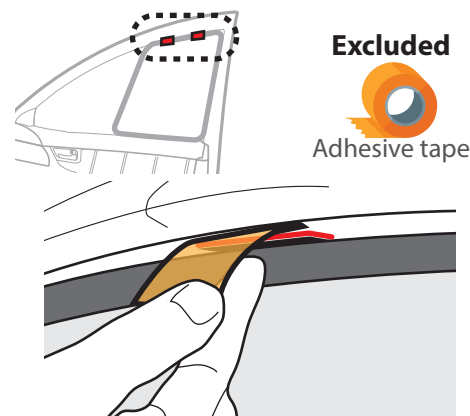

5

Use adhesive tape (not included in set) to mark the location where the L-Clips will be placed.

## ■ Cleaning, Preparing surface and Installing L-Clips

**6** Wind the window halfway down. Clean installation points with the alcohol pad at the tape label positions. Wait for 30 seconds before starting Step 7.

**7** Apply primer at installation points. Wait - 30 seconds. The purpose is to increase adhesive efficiency between surface and tape.

**▲** Apply primer **ONLY** if surface has been treated or polished.

**8** Attached L-Clips at tape label positions

## ■ Sunshade Installation Guide

### Front door with L-clip

**1** Place the sunshade against the glass panel, ensuring a gap between the door panel and the sunshade.

**2** Attach the L-Clip to the top edge of the sunshade.

### Rear door with L-clip

**1** Place the sunshade against the glass panel, ensuring a gap between the door panel and the sunshade.

**2** Attach the L-Clip to the top edge of the sunshade.

### 3rd row window without L-clip (SUV/MPV only)

**1** Place the sunshade against the glass panel.

**2** The sunshade is secured by the window frame.

**▲ AVOID** use of sunshade when driving vision is impaired