

BACK WINDSHIELD SHADE INSTALLATION GUIDE

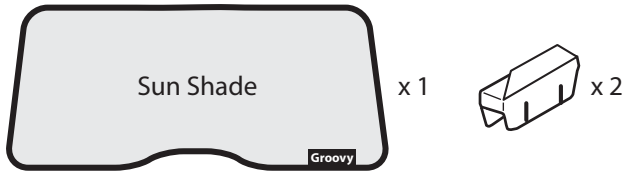

Parts List



Recommended Clip Installation Positions

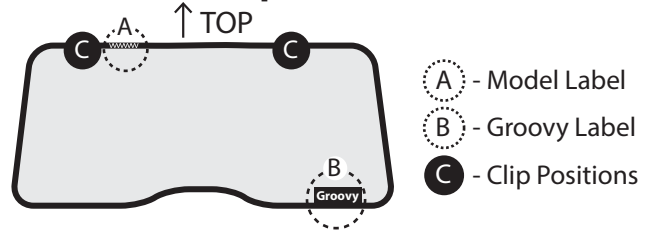

Installation Guide

⚠️ AVOID use of sunshade when driving vision is impaired

1a Place clip to the side of the steel frame.

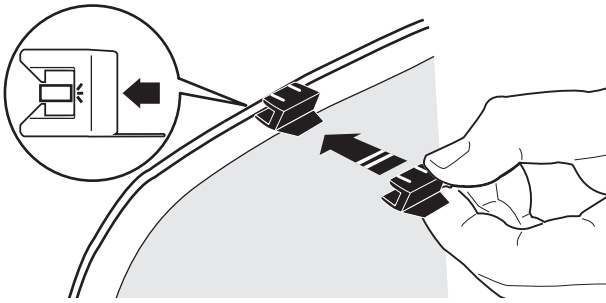

1b Push clip upwards to fasten clip onto steel frame.

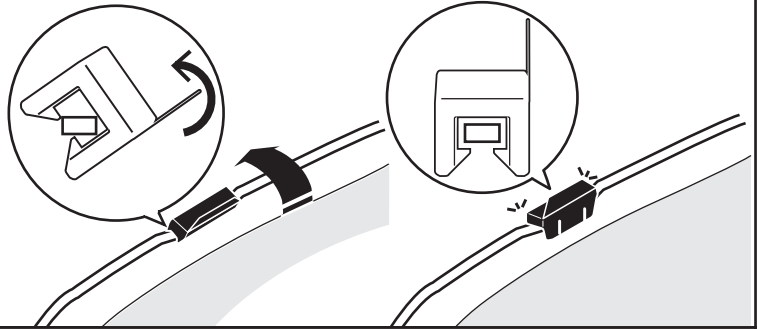

2 Slide the bottom section of the shade to the end of the rear parcel shelf

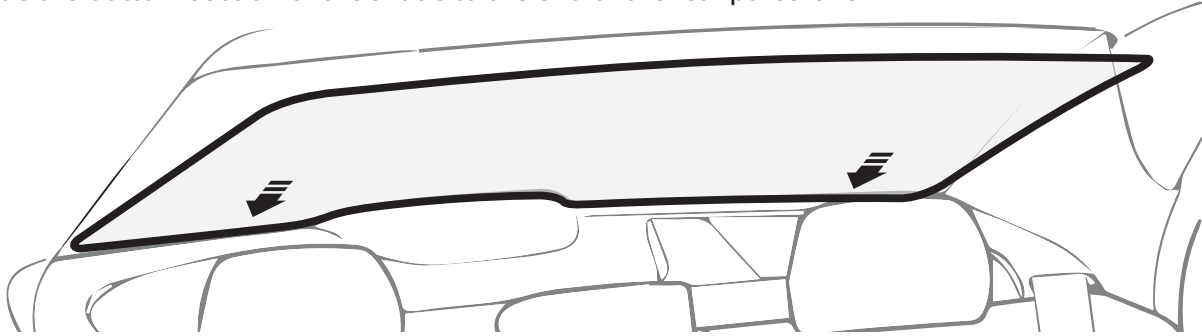

3 With the top clips locked into place, push the top section of the shade into the roof lining edge. The flat tip of the clips will sit in between the roof lining and the windscreen glass.

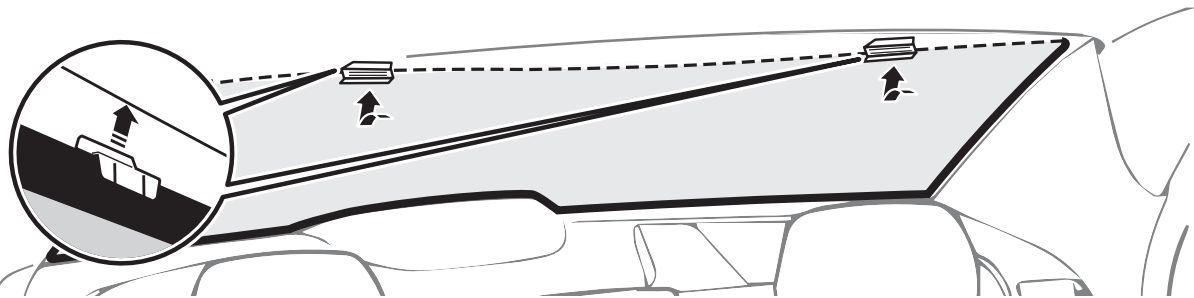

4 Once the rear windscreen shade is in position. Adjust the shade from the 2 sides for a better fit.

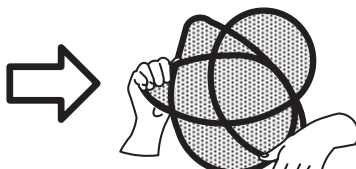
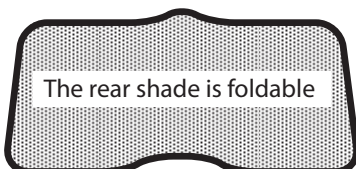
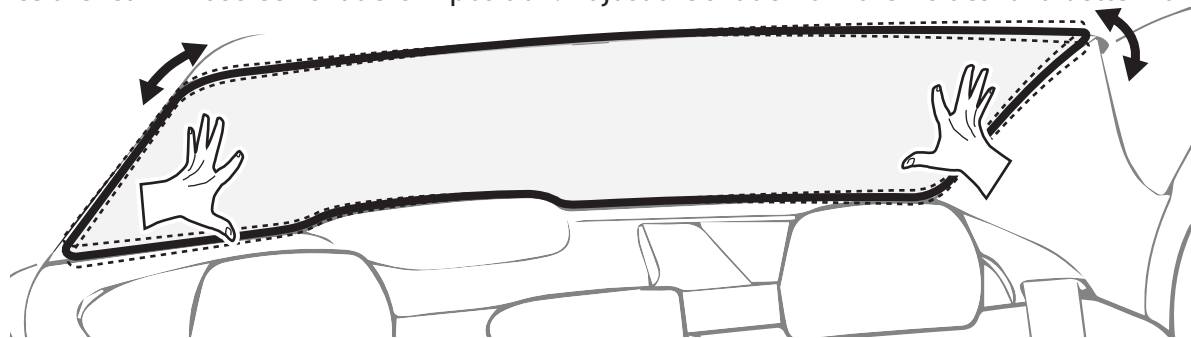

⚠️ Warning : The high tension from the collapsed steel frame may cause injury. Please be cautious when unfolding the collapsed rear shade.