

SUNROOF SHADE INSTALLATION GUIDE



Groovy™

⚠ **Remove** sunroof/panoramic sunshade(s) first before retracting the vehicle's sunroof/panoramic roof

S-4R-A-L

Parts List

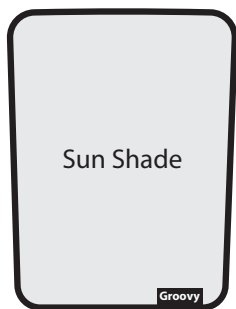

x 1

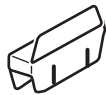

x 4

Recommended Clip Installation Positions

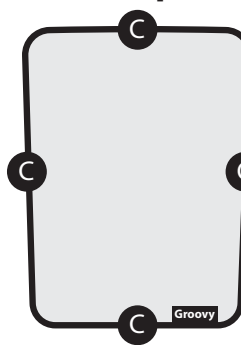

↑ FRONT

C - Clip Positions

Installation Guide

1a. Place clip to the side of the steel frame.

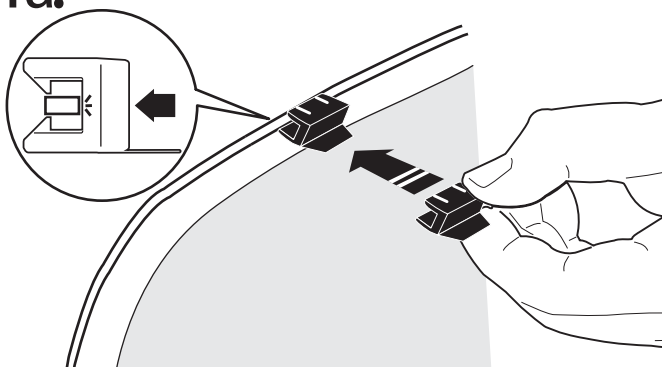

1b. Push clip upwards to fasten clip onto steel frame.

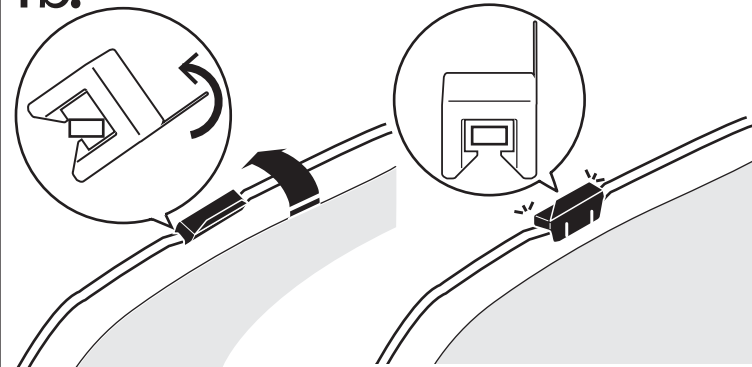

2. With the top clip locked into place, push the front section of the shade into the trim panel. The flat tip of the clip will sit in between the trim panel and sunroof glass.

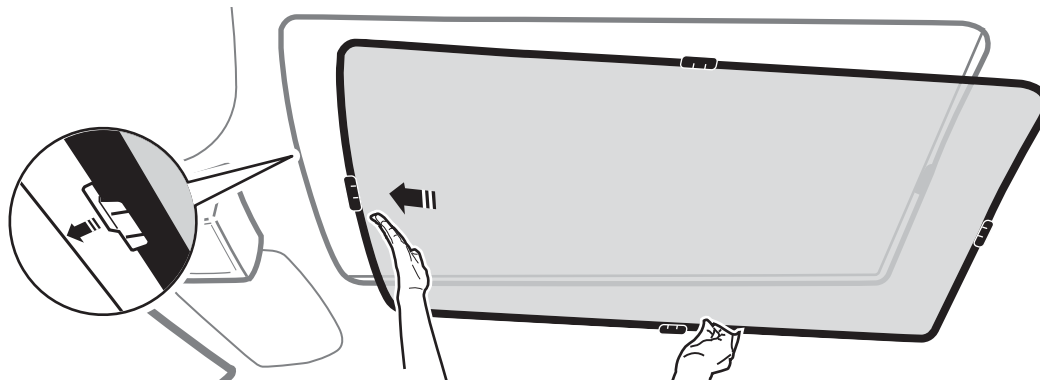

3. Repeat step 2 for the sides and rear section of the shade.

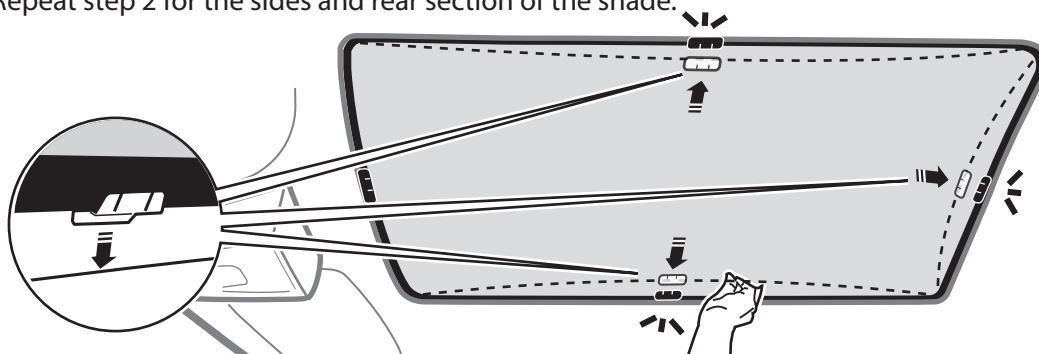

The sunroof shade is foldable

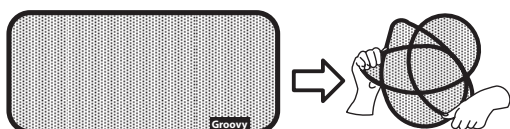

⚠ **Warning :** The high tension from the collapsed steel frame may cause injury. Please be cautious when unfolding the collapsed shade.

We at Groovy Shades value creativity and will pursue all legal avenues at our disposal to protect our product worldwide.

■ Patent - Taiwan, China, Japan, USA & Germany, South Korea, Thailand, Malaysia and India

Any unauthorized reproductions, use or disclosure of this material, or any part thereof, is strictly prohibited.